



GRINKLE PARK  
HOTEL

# An elegant country house

## *Meetings & Events in North Yorkshire Moors*

- CONFERENCES
- MEETINGS
- TRAINING
- INTERVIEWS
- SEMINARS
- PRIVATE DINING
- LAUNCHES & PRESENTATIONS
- TEAM BUILDING

CONFERENCES FOR UP TO 180 DELEGATES, TRAINING COURSES, BOARD MEETINGS, OR INTERVIEWS



Cradled between the North Yorkshire Moors and the coast, Grinkle Park is an elegant Victorian country house built in a baronial style, set in 300 acres.

The hotel has elegant lounges with roaring open fires and an imposing snooker room. Among the original features are high embossed ceilings and elegant wooden wall panelling.

Each of the 20 bedrooms has its own individual style and character and many have views across the gardens and grounds.

The extensive grounds contain a lake as well as classical statues and peacocks. Should you have spare time on your hands you can enjoy croquet and tennis or take to the Jogging Trail. The Grinkle Estate is adjacent to the hotel and is well known for its rough shooting as well as for plentiful partridge and pheasant.

Whatever the nature of your requirement, the Conference and Banqueting Team can tailor an event to match your precise requirements and they will be on hand throughout to make sure that everything runs smoothly.

*“We have held our annual conference at Grinkle Park for two consecutive years. Grinkle Park is perfect and has the flexibility to meet all our requests. The team building event organised by the hotel, was carried out with enthusiasm and energy.”*

PC Industries

WIRELESS  
BROADBAND  
AVAILABLE



GRINKLE PARK  
HOTEL

## Meetings & Events

### ROOM DETAILS

ROOM NAME	LOCATION	DAYLIGHT	ROOM DIMENSIONS			ROOM CAPACITIES					
			LENGTH	WIDTH	HEIGHT	THEATRE	CLASSROOM	U-SHAPE	BOARDROOM	DINNER/DANCE	RECEPTION
Palmer Suite	Ground	✓	17	10	3.5	180	80	60	60	150	150
Camellia Room	Ground	✓	11	7	3.5	50	35	15	15	40	40
Drawing Room	First	✓	8	4	3	-	-	12	12	-	-

- 20 BEDROOMS  
*Elegantly decorated & tastefully furnished*
- CONFERENCES  
*In natural daylight and quiet surroundings*
- COMPETITIVE DAY AND 24 HOUR DELEGATE RATES
- 24 HOUR TECHNICAL SUPPORT
- BUSINESS SERVICES
- EASY ACCESS FROM THE A171
- FREE PARKING

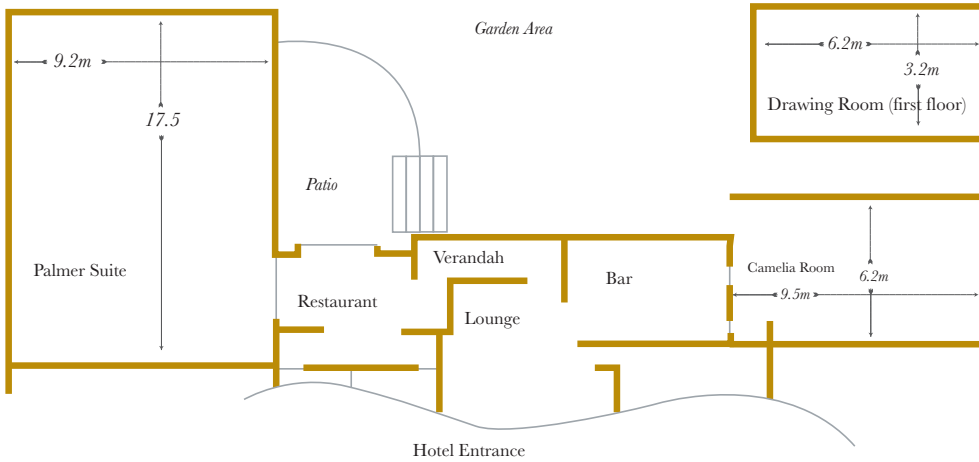

The new Palmer Suite is one of the largest in the vicinity and provides a superb venue for meetings for up to 180 delegates, dinner dances for up to 150 or a substantial exhibition space.

The suite opens on to an attractive patio that overlooks the grounds and has impressive views towards Redcar.

Two further rooms, the Camellia and the Drawing Room are perfect for smaller meetings, training, interviews or private dinners for up to 40 guests.

These rooms are all situated in a quiet part of the hotel, allowing delegates to enjoy a high degree of privacy.

The grounds and the neighbouring estate provide opportunities for team building challenges barbecues and sporting pursuits such as archery, laser clay pigeon shooting and mountain biking.

For further details on the facilities, please go to [www.classiclodges.co.uk](http://www.classiclodges.co.uk)

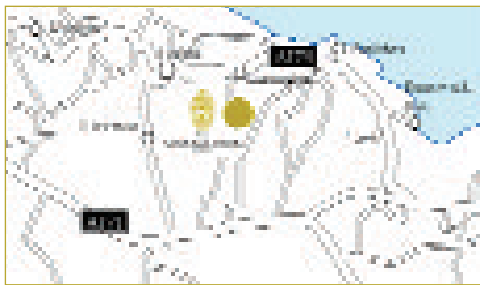

**By Road** Grinkle Park Hotel is situated 9 miles from Guisborough, signed left off the main A171 Guisborough-Whitby Rd.

**By Rail** Darlington Station 45 mins

**By Air** Teeside Airport 35 Mins



THE GRINKLE PARK HOTEL

Grinkle Lane, Easington, Saltburn-by-the-Sea, Cleveland, TS13 4UB